

PRECAST BASES

All bases can be made raw, with masonry (clad with firebrick casting compound) or with masonry including fine plaster

With drawer square version

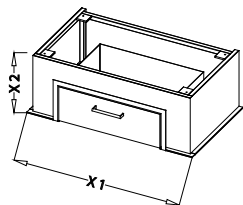

60	80	90	100	100XL	110XL
H= 860	H= 860	H= 860	H= 860	H= 860	H= 860
X1=580	X1=780	X1=880	X1=980	X1=980	X1=1080
X2=350	X2=350	X2=350	X2=350	X2=350	X2=350

With drawer arch version

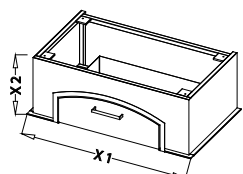

60	80	90	100	100XL	110XL
H= 860	H= 860	H= 860	H= 860	H= 860	H= 860
X1=580	X1=780	X1=880	X1=980	X1=980	X1=1080
X2=350	X2=350	X2=350	X2=350	X2=350	X2=350

With drawer chamfered version

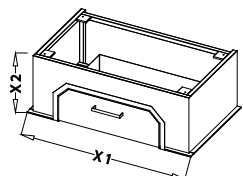

60	80	90	100	100XL	110XL
H= 860	H= 860	H= 860	H= 860	H= 860	H= 860
X1=580	X1=780	X1=880	X1=980	X1=980	X1=1080
X2=350	X2=350	X2=350	X2=350	X2=350	X2=350

With segment arch

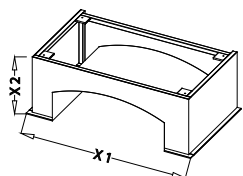

60	80	90	100	100XL	110XL
H= 860	H= 860	H= 860	H= 860	H= 860	H= 860
X1=580	X1=780	X1=880	X1=980	X1=980	X1=1080
X2=350	X2=350	X2=350	X2=350	X2=350	X2=350

With round arch

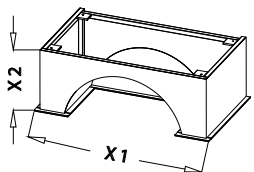

60	80	90	100	100XL	110XL
H= 860	H= 860	H= 860	H= 860	H= 860	H= 860
X1=580	X1=780	X1=880	X1=980	X1=980	X1=1080
X2=350	X2=350	X2=350	X2=350	X2=350	X2=350

Dimensions for the manufacture of a base on site (minimum dimensions)

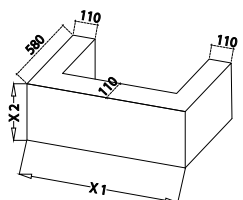

60	80	90	100	100XL	110XL
H= 860	H= 860	H= 860	H= 860	H= 860	H= 860
X1=580	X1=780	X1=880	X1=980	X1=980	X1=1080
X2=380	X2=380	X2=380	X2=380	X2=380	X2=380

SELF-CLOSING DRAWERS

All bases can be made raw, with masonry (clad with firebrick casting compound) or with masonry including fine plaster

Square version

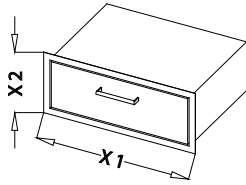

60	80	90	100	100XL	110XL
H= 860	H= 860	H= 860	H= 860	H= 860	H= 860
X1=360	X1=640	X1=740	X1=840	X1=840	X1=940
X2=300	X2=300	X2=300	X2=300	X2=300	X2=300

Arch version

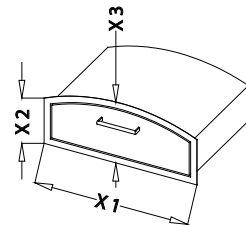

60	80	90	100	100XL	110XL
H= 860	H= 860	H= 860	H= 860	H= 860	H= 860
X1=360	X1=640	X1=740	X1=840	X1=840	X1=940
X2=215	X2=215	X2=215	X2=215	X2=215	X2=215
X3=300	X3=300	X3=300	X3=300	X3=300	X3=300

Chamfered version

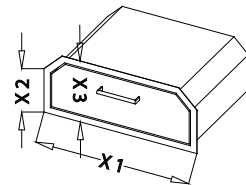

60	80	90	100	100XL	110XL
H= 860	H= 860	H= 860	H= 860	H= 860	H= 860
X1=360	X1=640	X1=740	X1=840	X1=840	X1=940
X2=215	X2=215	X2=215	X2=215	X2=215	X2=215
X3=300	X3=300	X3=300	X3=300	X3=300	X3=300

CLADDING IN MASONRY



Without cladding



Lining with refractory



Application of reinforcement and anti-cracking mesh



Coarse plaster



Completion with finish plaster