

ZOCCOLI PREFABBRICATI

Tutti gli zoccoli possono essere richiesti senza muratura, murati grezzi o murati ed intonacati

Con cassettone
versione
squadrata

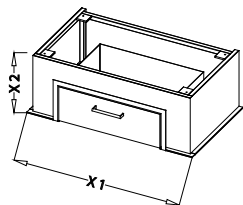

60	80	90	100	100XL	110XL
H= 860	H= 860	H= 860	H= 860	H= 860	H= 860
X1=580	X1=780	X1=880	X1=980	X1=980	X1=1080
X2=350	X2=350	X2=350	X2=350	X2=350	X2=350

Con cassettone
versione ad arco

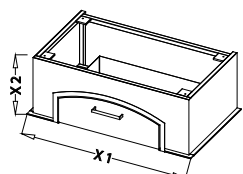

60	80	90	100	100XL	110XL
H= 860	H= 860	H= 860	H= 860	H= 860	H= 860
X1=580	X1=780	X1=880	X1=980	X1=980	X1=1080
X2=350	X2=350	X2=350	X2=350	X2=350	X2=350

Con cassettone
versione bisellato

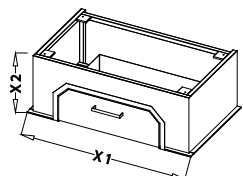

60	80	90	100	100XL	110XL
H= 860	H= 860	H= 860	H= 860	H= 860	H= 860
X1=580	X1=780	X1=880	X1=980	X1=980	X1=1080
X2=350	X2=350	X2=350	X2=350	X2=350	X2=350

Versione
ad arco

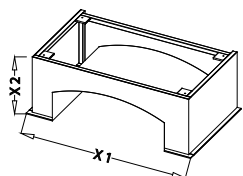

60	80	90	100	100XL	110XL
H= 860	H= 860	H= 860	H= 860	H= 860	H= 860
X1=580	X1=780	X1=880	X1=980	X1=980	X1=1080
X2=350	X2=350	X2=350	X2=350	X2=350	X2=350

Versione a
mezza luna

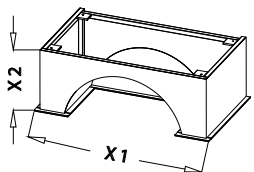

60	80	90	100	100XL	110XL
H= 860	H= 860	H= 860	H= 860	H= 860	H= 860
X1=580	X1=780	X1=880	X1=980	X1=980	X1=1080
X2=350	X2=350	X2=350	X2=350	X2=350	X2=350

Indicazioni per
l'esecuzione in
opera dello zoccolo
in muratura
(misure minime)

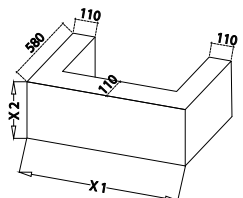

60	80	90	100	100XL	110XL
H= 860	H= 860	H= 860	H= 860	H= 860	H= 860
X1=580	X1=780	X1=880	X1=980	X1=980	X1=1080
X2=380	X2=380	X2=380	X2=380	X2=380	X2=380

CASSETTONI CON GUIDE SERVOASSISTITE

Tutti gli zoccoli possono essere richiesti senza muratura, murati grezzi o murati ed intonacati

Versione squadrata

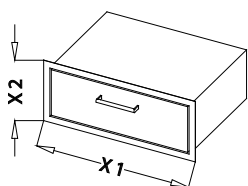

60	80	90	100	100XL	110XL
H= 860	H= 860	H= 860	H= 860	H= 860	H= 860
X1=360	X1=640	X1=740	X1=840	X1=840	X1=940
X2=300	X2=300	X2=300	X2=300	X2=300	X2=300

Versione ad arco

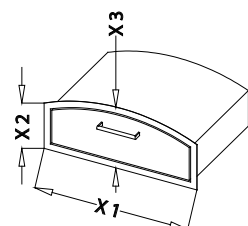

60	80	90	100	100XL	110XL
H= 860	H= 860	H= 860	H= 860	H= 860	H= 860
X1=360	X1=640	X1=740	X1=840	X1=840	X1=940
X2=215	X2=215	X2=215	X2=215	X2=215	X2=215
X3=300	X3=300	X3=300	X3=300	X3=300	X3=300

Versione bisellato

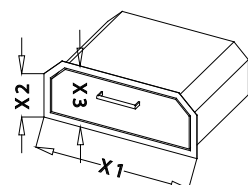

60	80	90	100	100XL	110XL
H= 860	H= 860	H= 860	H= 860	H= 860	H= 860
X1=360	X1=640	X1=740	X1=840	X1=840	X1=940
X2=215	X2=215	X2=215	X2=215	X2=215	X2=215
X3=300	X3=300	X3=300	X3=300	X3=300	X3=300

RIVESTIMENTO IN MURATURA



Senza rivestimento



Rivestimento con refrattario



Applicazione rete di armatura ed antifessurazione



Rasatura



Finitura finale