

# 80 PREFABRICATED WOOD STOVE

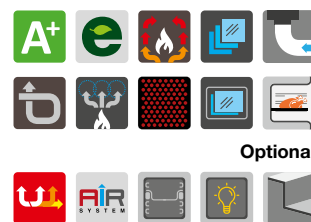

Measurements (W x D x H): 800 x 600 x 480 mm  
Nominal heating power: 8 kW  
Heating efficiency: 83,8%  
Patented adjustable multiple smoke outlet  
Available with oven right or left



PANORAMA  
Stainless steel



DEKOR  
ST31



TREND  
Stainless steel



# 80 PREFABRICATED

## WOOD STOVE - OVEN ON RIGHT

### Technical data (Data may vary depending on type of fuel used)

Fuel	Wood
Energy efficiency class	A+
Nominal heating power	8 kW
Heating efficiency	83,8 %
$\eta_s$ Seasonal space heating energy efficiency	74,8 %
Diameter smoke outlet	Ø 120 mm
Minimum draught	12 Pa / 0,12 mbar
Temperature smoke outlet	212 °C
Smoke mass	6,6 g/s
CO at 13% O <sub>2</sub>	0,11 %
Weight	175 kg
Possible smoke outlets	5
Test report	C-1076392-1 rev.01
VKF AEA1 - No.	16685
Firebox opening version Trend/Dekor (L x H)	165 x 165 mm
Firebox opening version Panorama (L x H)	165 x 180 mm
Combustion chamber (L x D x H)	200 x 400 x 260 mm
Drawer (L x D x H)	-
Oven (L x D x H)	260 x 420 x 265 mm
Hob (L x D)	650 x 460 mm
Diameter external air intake	Ø 80 mm
CO at 13% O <sub>2</sub> (Carbon monoxide) / NOx (Nitrogen oxide)	1363,0 mg/Nm <sup>3</sup> / 52,0 mg/Nm <sup>3</sup>
Dust / OGC (Organic compounds)	39,0 mg/Nm <sup>3</sup> / 49,0 mg/Nm <sup>3</sup>

On request with Air System fireproof protection unit (optional)

On request with walls built and plastered (optional)

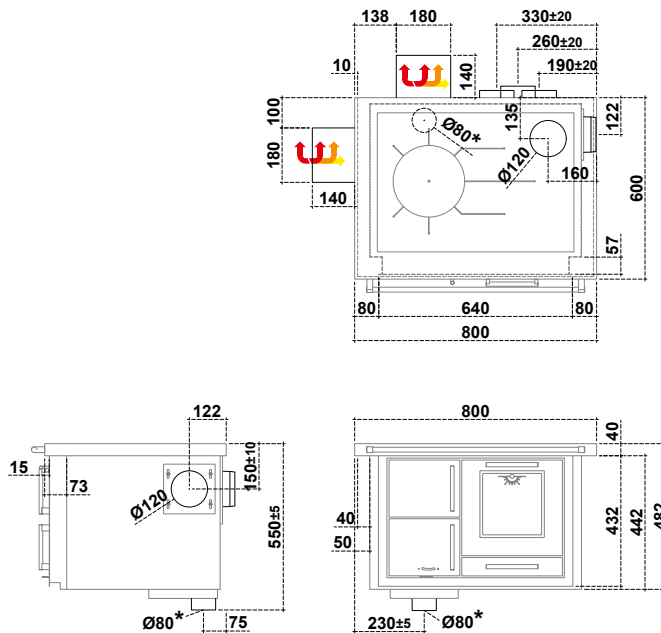

For the version with the oven light (optional), install a Schuko socket either behind the wood drawer at a maximum height of 130 mm from the floor, or at a maximum distance from the kitchen stove of 500 mm (the oven light switch must be fitted by the installer).

\* External air intake

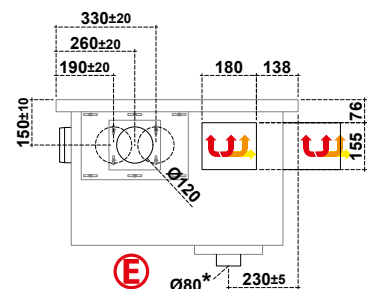

### WARNING:

#### Minimum safety distance from flammable materials

From the rear and side connection to the chimney * 40mm of insulation with heat conductivity equal to 0.1 W/mK at 200°C	<b>P= 0 + 40* mm</b> <b>Following agreement with chimney sweep</b>
On the side above the plate	<b>L= 400 mm</b>
On the side below the plate (only with Air System fireproof protection unit)	<b>L= 3 mm</b>
Above the plate	<b>Min. 750 mm</b>
In the front from the middle of the fire door	<b>R= 250 mm</b>
Plate for floor protection	<b>Based on specific country directives</b>

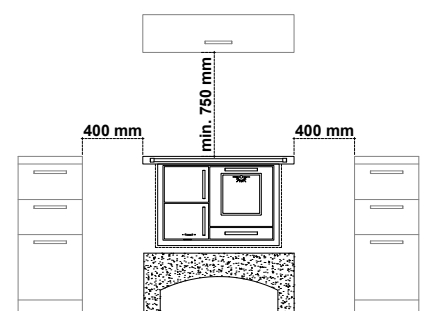

# 80 PREFABRICATED

## WOOD STOVE - OVEN ON LEFT

### Technical data (Data may vary depending on type of fuel used)

Fuel	<b>Wood</b>
Energy efficiency class	<b>A+</b>
Nominal heating power	<b>8 kW</b>
Heating efficiency	<b>83,8 %</b>
$\eta_s$ Seasonal space heating energy efficiency	<b>74,8 %</b>
Diameter smoke outlet	<b>Ø 120 mm</b>
Minimum draught	<b>12 Pa / 0,12 mbar</b>
Temperature smoke outlet	<b>212 °C</b>
Smoke mass	<b>6,6 g/s</b>
CO at 13% O <sub>2</sub>	<b>0,11 %</b>
Weight	<b>175 kg</b>
Possible smoke outlets	<b>5</b>
Test report	<b>C-1076392-1 rev.01</b>
VKF AEA1 - No.	<b>16685</b>
Firebox opening version Trend/Dekor (L x H)	<b>165 x 165 mm</b>
Firebox opening version Panorama (L x H)	<b>165 x 180 mm</b>
Combustion chamber (L x D x H)	<b>200 x 400 x 260 mm</b>
Drawer (L x D x H)	<b>-</b>
Oven (L x D x H)	<b>260 x 420 x 265 mm</b>
Hob (L x D)	<b>650 x 460 mm</b>
Diameter external air intake	<b>Ø 80 mm</b>
CO at 13% O <sub>2</sub> (Carbon monoxide) / NOx (Nitrogen oxide)	<b>1363,0 mg/Nm<sup>3</sup> / 52,0 mg/Nm<sup>3</sup></b>
Dust / OGC (Organic compounds)	<b>39,0 mg/Nm<sup>3</sup> / 49,0 mg/Nm<sup>3</sup></b>

On request with Air System fireproof protection unit (optional)

On request with walls built and plastered (optional)

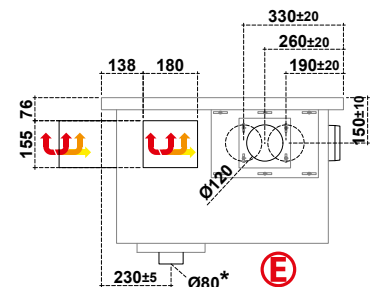
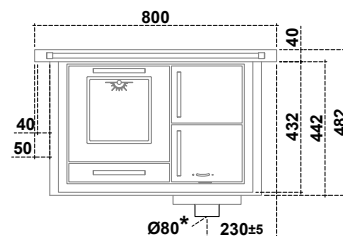
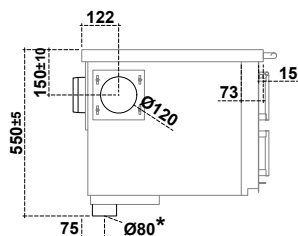
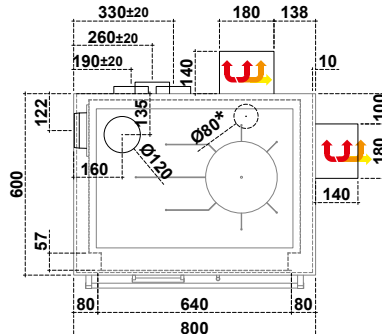

For the version with the oven light (optional), install a Schuko socket either behind the wood drawer at a maximum height of 130 mm from the floor, or at a maximum distance from the kitchen stove of 500 mm (the oven light switch must be fitted by the installer).

\* External air intake

### WARNING:

#### Minimum safety distance from flammable materials

From the rear and side connection to the chimney * 40mm of insulation with heat conductivity equal to 0.1 W/mK at 200°C	<b>P= 0 + 40* mm</b> <b>Following agreement with chimney sweep</b>
On the side above the plate	<b>L= 400 mm</b>
On the side below the plate (only with Air System fireproof protection unit)	<b>L= 3 mm</b>
Above the plate	<b>Min. 750 mm</b>
In the front from the middle of the fire door	<b>R= 250 mm</b>
Plate for floor protection	<b>Based on specific country directives</b>

