

# 70 ÖKOALPIN

## WOOD STOVE



Measurements (W x D x H): 700 x 600 x 850-910 mm  
 Nominal heating power: 7 kW  
 Heating efficiency: 80,7%  
 Patented adjustable multiple smoke outlet  
 Available with oven right or left



TREND  
 Stainless steel



DEKOR  
 ST37



PANORAMA  
 Sand F7



# 70 ÖKOALPIN

## WOOD STOVE



### Technical data (Data may vary depending on type of fuel used)

Fuel	Wood
Energy efficiency class	A+
Nominal heating power	7 kW
Heating efficiency	80,7 %
$\eta_s$ Seasonal space heating energy efficiency	71,7 %
Diameter smoke outlet	Ø 120 mm
Minimum draught	12 Pa / 0,12 mbar
Temperature smoke outlet	244 °C
Smoke mass	10,2 g/s
CO at 13% O <sub>2</sub>	0,11 %
Weight	195 kg
Possible smoke outlets	5
Test report	CPD-11-024
VKF AEA1 - No.	16685
Firebox opening version Trend/Dekor (L x H)	165 x 165 mm
Firebox opening version Panorama (L x H)	165 x 180 mm
Combustion chamber (L x D x H)	170 x 400 x 260 mm
Drawer (L x D x H)	420 x 420 x 290 mm
Oven (L x D x H)	260 x 420 x 265 mm
Hob (L x D)	600 x 500 mm
Diameter external air intake	Ø 80 mm
CO at 13% O <sub>2</sub> (Carbon monoxide) / NO <sub>x</sub> (Nitrogen oxide)	1359,0 mg/Nm <sup>3</sup> / 61,0 mg/MJ
Dust / OGC (Organic compounds)	17,9 mg/Nm <sup>3</sup> / 30,0 mg/MJ

**NB:** Available with door stop left or right

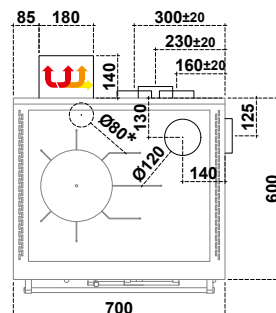

For the version with the oven light (optional), install a Schuko plug either behind the wood drawer at a maximum height of 320 mm from the floor, or at a maximum distance from the kitchen stove of 500 mm

\* External air intake

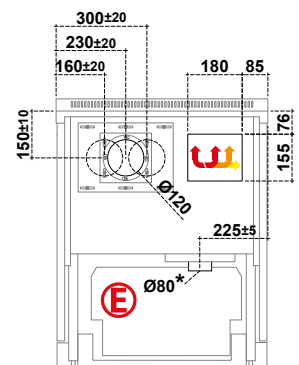
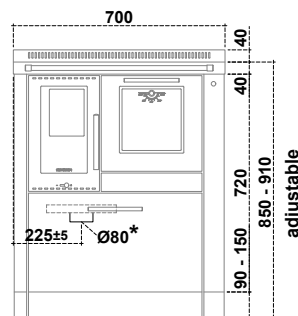
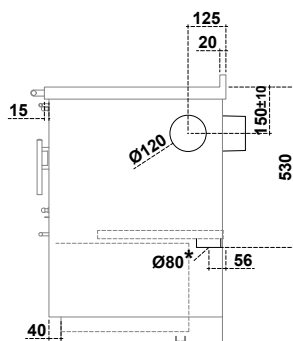

### WARNING:

#### Minimum safety distance from flammable materials

From the rear and side connection to the chimney

**P= 0 + 40\* mm**  
Following agreement with chimney sweep

\* 40mm of insulation with heat conductivity equal to 0.07 W/mK at 200°C

On the side above the plate

**L= 400 mm**

On the side below the plate

**L= 3 mm**

Above the plate

**Min. 750 mm**

In the front from the middle of the fire door

**R= 250 mm**

Plate for floor protection

**Based on specific country directives**

